

FIBER LASER BMFD

20W | 50W | 100W

High precision 2D and 3D marking



A family of powerful and reliable fiber lasers

BMFD lasers are designed for high-speed on-line integration and for use in standalone workstations. They are ideal for demanding metal marking applications, but are also effective with other materials such as plastics and composite materials.

BMFD lasers are long life, low maintenance lasers with very low cost of ownership.

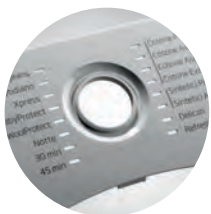

BMFD is much more than a laser system

The BMFD range of lasers are fast and powerful, available in several powers for appropriate results according to each material and company.

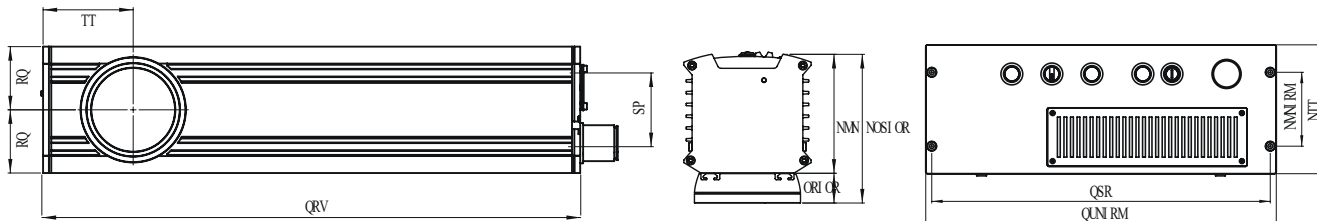

BMFD													
MODEL		PULSED & PULSED UHS											
POWER		20W			50W			100W					
WAVELENGTH		1.062 μm											
FREQUENCY		25-100Kħ											
PULSE WIDTH		100ns											
LASER SYSTEM		BMFD020 PULSED & PULSED UHS			BMFD050 PULSED & PULSED UHS			BMFD100 PULSED & PULSED UHS					
MAINS SUPPLY		100V - 240V 50 / 60 Hz (1 Phase + N) 350 VA			100V - 240V 50 / 60 Hz (1 Phase + N) 600 VA			100V - 240V 50 / 60 Hz (1 Phase + N) 750 VA					
DIMENSIONS		Head		108x106.5x469 mm			115x98x463 mm						
		Rack		464x177x550 mm									
WEIGHT		Net weight: 23Kg - Gross Weight: 27Kg											
SYSTEM		Optical isolator and collimator of the laser source, galvanometric scanners built into the marking head. Control and power electronics, drivers of the scanners, CPU, power supplies and laser source built into the control rack.											
FOCAL SPECIFIC.		TECHNOLOGY			PULSED				PULSED UHS				
					F -	20	50	100	F -	20	50	100	
		MA (mm)	WD (mm)	FL (mm)	BD (μm)	PD (KW/cm ²)	PD (KW/cm ²)	PD (KW/cm ²)	BD (μm)	PD (KW/cm ²)	PD (KW/cm ²)	PD (KW/cm ²)	
		55x55	141	100	16	19417	48542	97085	27	6964	17409	34819	
		100x100	205	163	26	7308	18270	36540	44	2653	6634	13267	
		168x168	347	254	41	3009	7524	15045	69	1079	2698	5397	
		212x212	458	346	56	1622	4054	8110	94	582	1454	2908	
242x242	554	420	68	1101	2752	5505	-	-	-	-			
560x560	889	815	132	292	731	1460	-	-	-	-			
SOFTWARE		<ul style="list-style-type: none"> • ScanLinux (Standard). • Crystal Font (Standard). • Internal Barcode. • Marca Lite Software. 											
USER INTERFACE		<ul style="list-style-type: none"> • Touch Screen. • Hand Held Terminal. • PC. 											
CONTROLLED BY		<ul style="list-style-type: none"> • Hand Held Terminal with ScanLinux software. • Touch Screen with ScanLinux software. • Full Graphics Interface: includes Marca™ software, dongle and Ethernet cable (TCP / IP). • Marca Lite Software: includes Marca™ software, dongle and Ethernet cable (TCP / IP). 											
ACCESSORIES		Handheld Terminal-Touch Screen Terminal - Beam pointer - Encoder Kit - Photocell Kit - Alarm Kit Fume Extractor - Mounting support - Mounting Bracket U-ARM - Marking paper - Protection goggles Air Cooling Kit											
ENVIRONMENTAL CONDITIONS		+15°C (59°F) at 40°C (104°F) external temperature with 50% Duty Cycle or 36°C(100°F) external temperature with 100% Duty Cycle. Humidity between 10% and 95%, without condensation. No vibrations.											

* **MA:** Marking Area | **FL:** Focal Length (The distance between the center of the lens and the surface to be marked.)
WD: Working Distance (The distance between the laser system base and the surface to be marked.)
BD: Spot Beam Diameter | **PD:** Power Density
 These values are an approximation, and they are different for each laser system, due to the different optical paths.

